



milovanfarronato@hotmail.com

Newsletter gratuite

Da: <kurt@hansopdebeeck.com>
Inviato: giovedì 15 dicembre 2005 14.12.24
A: milovanfarronato@hotmail.com
Cc: hans@hansopdebeeck.com, stijn@hansopdebeeck.com

Posta in a

hotels.com advertisement for 'VACANZA BREVE?' featuring a cityscape image.

Dear Milovan,

I received your feedback about 'Loss' and discussed it with Stijn and Hans:

At first we would like to say that we aren't in the habit of an exchange of a drawing for a production of an installation. However, we realise that the installation we want to make is a bit more complicated than the one you have seen in Miami.

I made some calculation about productioncost. Like you said, the only cost will be that of the material. The actually construction will be sponsored. The amount I estimated is that of the wood (60x mdf panels (3mm), 180x beams 36X36X240) the paint and screws: 2000euro (that is without the rent or purchase of the projection and sound installation).

NO

A drawing costs 5000euro. So there will be a lot of profit for the director. Because of the favor we will do when we agree with the deal, we want to have a perfect installation. The installation should therefore be well made, that is professional quality. And we want to use it again.

Because of this profit and the aim for good quality, we can only agree with the deal, under a few conditions:

- 1. The construction of the installation should be finished by the 8th of January 2006, so that the assembling can start on the 9th.
2. I (Kurt) will come over the 4th of January: to make sure that the installation is well made and to help with sculptural aspects.
3. For the assembling I need two assistants (the guys you mentioned before sound okay).
4. I need to be able to work after the official working hours (for instance until 22:00 or 23:00) both in the VIAFARINI as in the studio where the installation will be made.
5. The transport of the installation (Milano-Brussels) will be paid by (the director of) the VIAFARINI or by sponsorship.
6. A per diem of 25euro each day that I (Kurt) stay in Milano. This goes as well for the visit and staying of Hans.
7. There should be transport facilities (bus, subway,?) between the studio where the installation is built, the VIAFARINI and my accommodation. (transport will be paid with the per diem!)

?

SI
? Si non orke
SI
SI

If you agree with these conditions, the construction can start as from today.

I only have to make a drawing which concerns the floor coverage: Wood in the projection space and carpet in the space where the people can sit.

Hope to hear from you soon (today?)

Greetz,
Kurt Geraerts



Posta in arrivo

MSN - Ogni giorno più utile

X **Mihovil**

Daniel

02 66 88 54 3

32 87 82 64 16

Ileana

339 319 1534

Monica (Monica)

0383 892416

Da: kurt@hansopdebeeck.com
Oggetto: **Re: Fwd: Confirmation of Booking with Virgin Express**
Data: 04 gennaio 2006 11:26:20 GMT+01:00
A: Viafarini <viafarini@viafarini.org>

Dear Viafarini,

I printed the flight confirmation. It looks okay but it says with payment details: "You must be prepared to produce a copy of the credit card used to make this booking." Do you think this will be a problem?

About the construction of the installation. We will send this week the paste to make the stone like surface.

I suppose that the viafarini and/or the assistant provide some equipment like: circular saw, *sepa circolare*, screw/drillmachine,

- sander, *catto vetro levigatrice?*
- hand saw,
- hammer,
- (wood)glue,
- polyester paste (2 component, no fibreglass), ?
- clamps,
- sandpaper,
- nails, screws....
- measure tools (up to 5m)

The address of the 'ViaFarini' is that the Via C. Farini near the train station?

with very best regards,
Kurt Geraerts

Dear Kurt,

I forward to you your confirmation of booking for the flight, which you will need to collect your ticket.
The material arrived this morning, so everything should be fine.
In case of any problem, my mobile number is +39-335-6666359.
On the 7th, Patrizia (mobile +39-335-8376643), Milovan (+39-347-8000431) and Mihovil (340-0922042) will be here.
I wish you a Happy New Year, and see you in January.

Monica

Viafarini
Via C. Farini 35
I-20159 Milano
tel / fax +39 02 66804473
viafarini@viafarini.org

N° 3	x	183	x	366	marca 1
N° 3	x	183	x	0,34	marca 1
N° 2	x	175	x	3,66	marca 2
N° 2	x	175	x	0,34	" 2
N° 2	x	0,875	x	3,66	" 3
N° 2	x	0,875	x	0,34	" 3
N° 2	x	0,60	x	3,66	" 4
N° 2	x	0,60	x	0,34	" 4
N° 2	x	200	x	150	" 5
N° 1	x	200	x	0,28	" 6
N° 1	x	200	x	0,10	" 7
N° 1	x	200	x	0,375	" 8
N° 1	x	200	x	0,75	" 9

N° 5

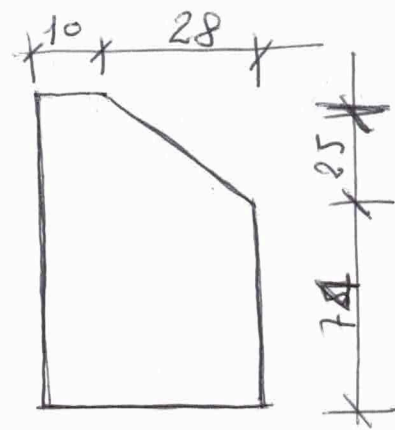

N° 40 LISTONI 4x5 da ml. 4.00

N° 10 TAVOLE DBETE ^(2,5) PIGNATE (SOTOMISURE)

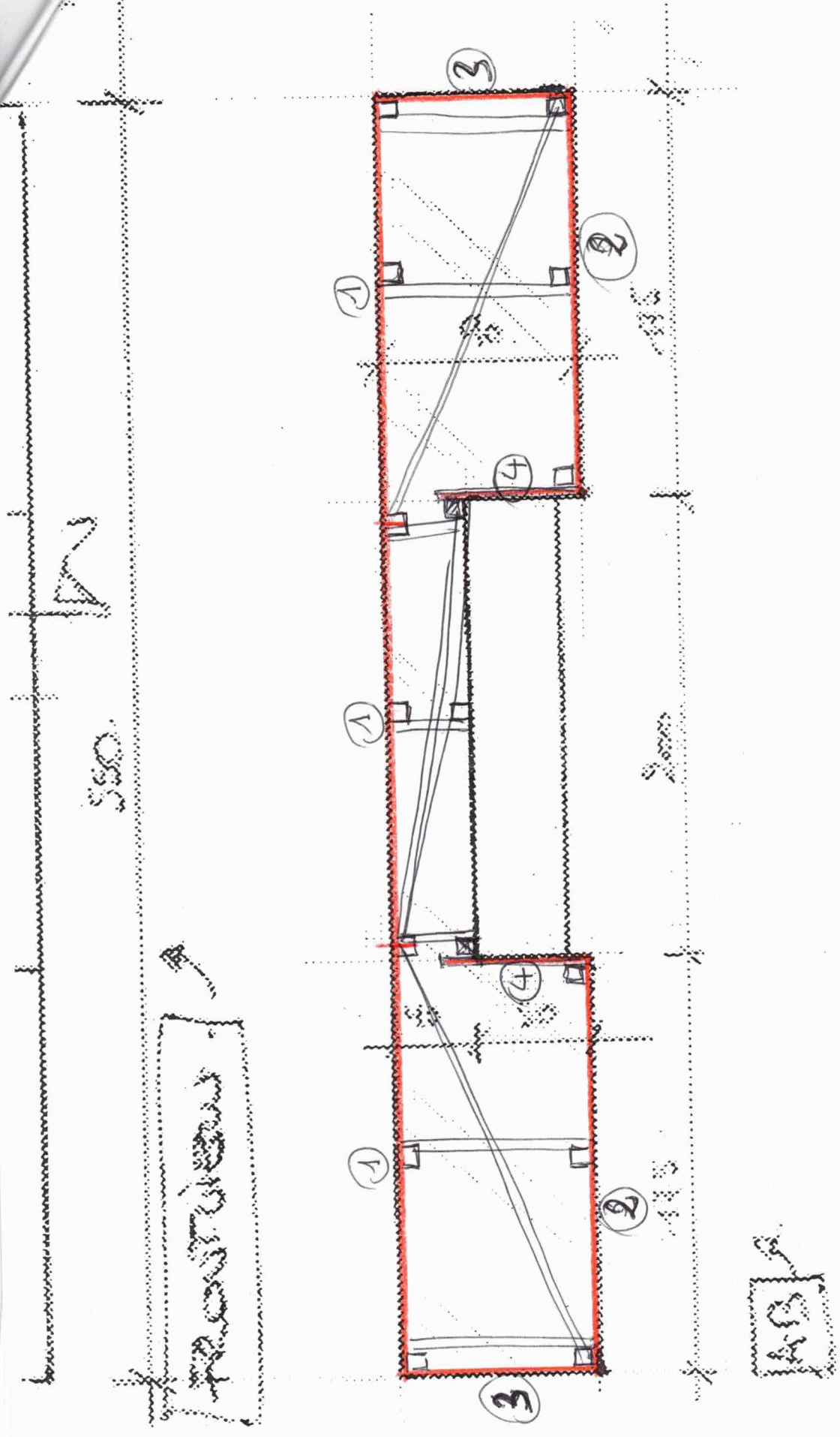

N.B. È CONSIGLIABILE FISSARE
IL TUTTO AL SOFFITTO

LEGGERI

LEGGERI S.p.A.
Costruzioni edili, civili ed industriali
Via Decò e Canetta n. 46
24068 SERIATE (Bergamo)
Tel. 035/29 43 03 - Fax 035/30 20 45
e-mail: amministrazione@leggeri.com
www.leggerigroup.it
cap. Soc. € 500.000,00
Reg. Impr. di Bergamo R.E.A. n. 138414
Cod. Fisc. e Part. IVA 00222810160

SPETT.LE
ASSOCIAZIONE VIA FARINI
VIA CARLO FARINI N. 35
20159 MILANO

Ns. rif.	Vs. rif.	Data	28 FEB 2006
----------	----------	------	-------------

OGGETTO: invio fattura per realizzazione struttura HANS OP DE BEECK

In allegato alla presente inviamo fattura n. 15 del 28/02/2006 per un importo pari a € 2.304,00.= per la realizzazione di cui all'oggetto.

Riportiamo in calce le coordinate bancarie per effettuare il bonifico a saldo della fattura di cui sopra:

BANCA POPOLARE DI BERGAMO
FILIALE DI SERIATE
C/C 421
ABI 05428
CAB 53510

Ringraziamo e cogliamo l'occasione per porgere cordiali saluti.

LEGGERI S.p.A.
Costruzioni Edili, Civili e Industriali
Via Decò e Canetta, 46
24068 SERIATE (BG)
Tel. 035/29.43.03
C.F. P. IVA 00222810160